

T-type

for Pie-cut Corner Cabinet

For wood doors

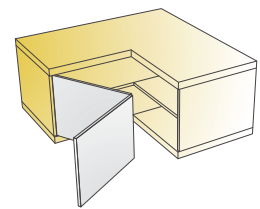

- Opening angle 70°
- Drilling diameter for hinge cup 35mm
- Drilling depth 11mm
- Hinge on plate mounting system 3Way snap-on



	Interaxis 45mm	Interaxis 48mm
Cup type	Item number	Item number
	721-0PK0-650	721-0PL0-650
	721-0PK4-650	721-0PL4-650

Corner cabinet

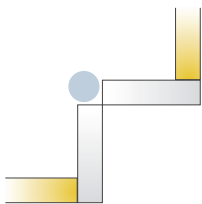

Drilling patterns for hinge cups → see page 2.17

100 Pcs

Cup made of zinc, arm made of steel

Mounting plates



Cam adjustable cruciform mounting plate
→ see page 2.81



Cruciform mounting plate
→ see page 2.83



Cam adjustable linear mounting plate
→ see page 2.81

Hinge cup screws If not pre-mounted

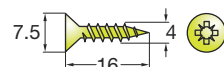

820-6328-050

10000 Pcs

Accessories



Cover caps for hinge arm
→ see page 2.177

Legend of hinge cup symbols



Screw-on ready
← screws



EasyFix



Door adjustment

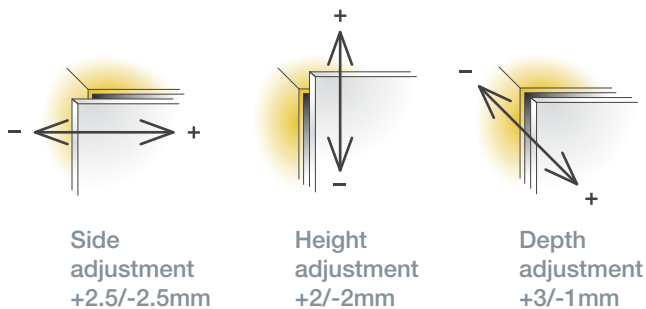

For further explanation → see pages 2.22-2.24

Mounting details

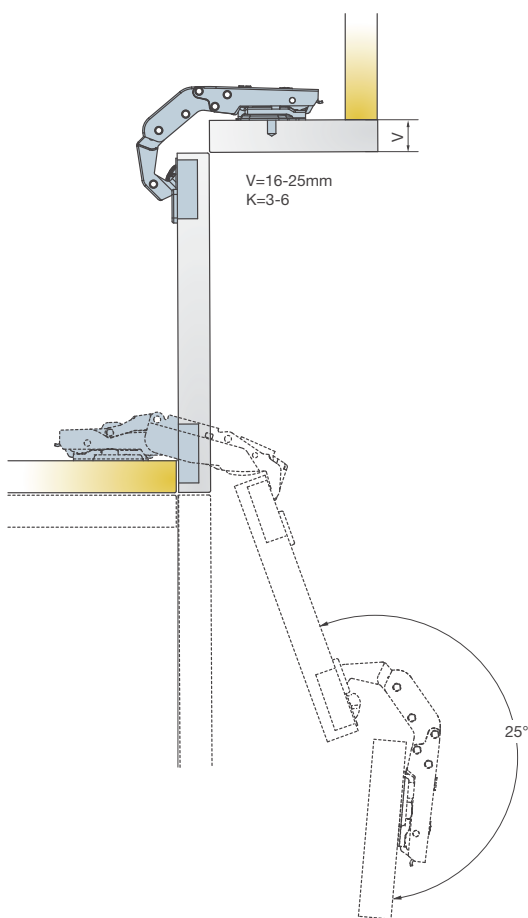

Mounting plate drilling distance

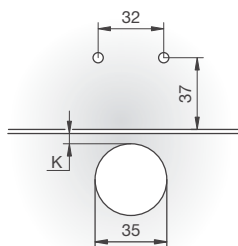

Any T-type mounting plate can be used

Adjustments

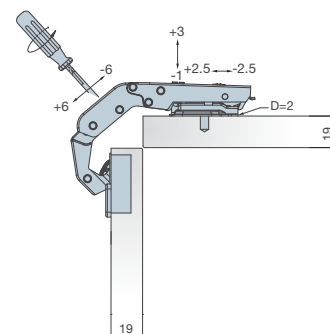

The adjustment of the gap between two doors is done by rotating the adjustment screw as shown on the drawing

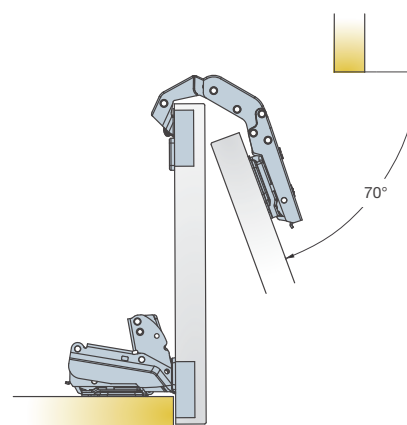

Touch opening



PushOpen Solutions
→ see pages 2.199-2.204

T-type Mounting Plates

3Way snap-on mounting

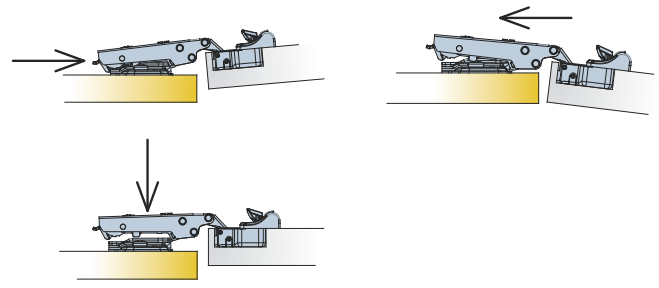

Drilling pattern

Dimensions

Cam adjustable cruciform mounting plate 37mm

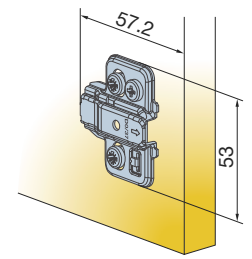
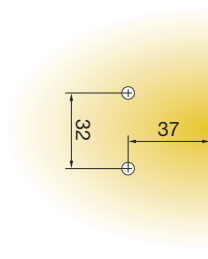

150 Pcs Made of steel

Cam adjustable linear mounting plate

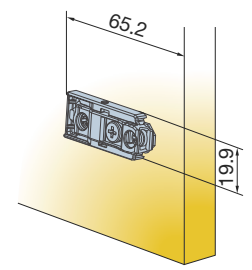
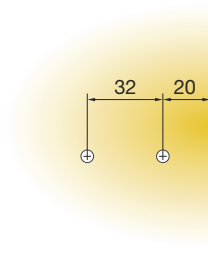

150 Pcs Made of steel and zinc

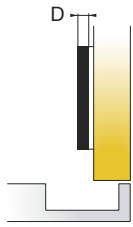

Mounting plate thickness

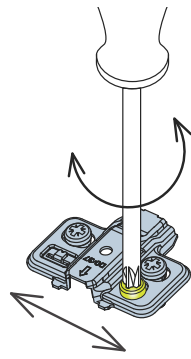

Height adjustment +2/-2mm

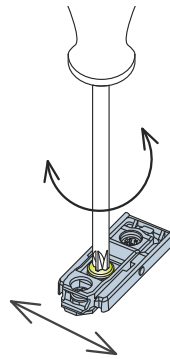

Height adjustment +2/-2mm

Mounting plate type	15		10.5	15	
Mounting plate thickness (D)				no pre-drilling required 	
Item number					
0mm	700-0KC0-054	700-0KB0-054	700-0KF0-054	700-0KA0-054	
1mm	700-0KC1-054	700-0KB1-054	700-0KF1-054	700-0KA1-054	
2mm	700-0KC2-054	700-0KB2-054	700-0KF2-054	700-0KA2-054	
3mm	700-0KC3-054	700-0KB3-054	700-0KF3-054	700-0KA3-054	
4mm	700-0KC4-054	700-0KB4-054	700-0KF4-054	700-0KA4-054	
0mm	700-0LC0-650	700-0LB0-650	700-0LF0-650		
2mm	700-0LC2-650	700-0LB2-650	700-0LF2-650		
3mm	700-0LC3-650	700-0LB3-650	700-0LF3-650		

Legend of mounting plate type symbols



Pre-mounted 15mm euro screws



Machine insertion ready



Pre-mounted 10.5mm expanding dowels



Pre-mounted chipboard screw

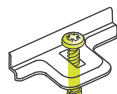
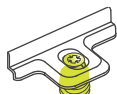
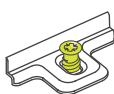

T-type Mounting Plates

3Way snap-on mounting

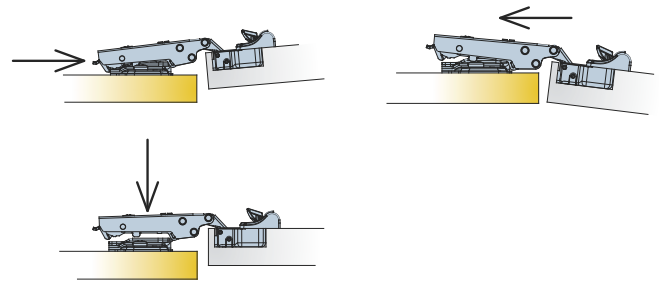

Cruciform mounting plate 37mm

Drilling pattern

Dimensions

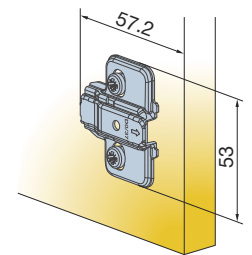
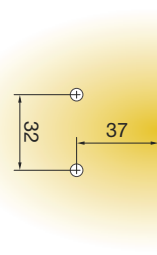

150 Pcs Made of steel

Cam adjustable
face frame mounting plate

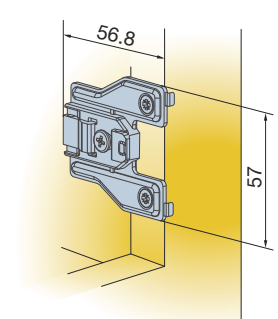
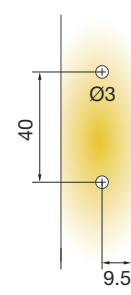

150 Pcs Made of steel and zinc

Fixing screw for cruciform mounting plate
If not pre-mounted

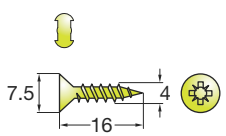

Chipboard screws
820-6328-050

10000 Pcs

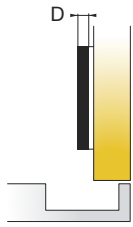

Mounting plate thickness

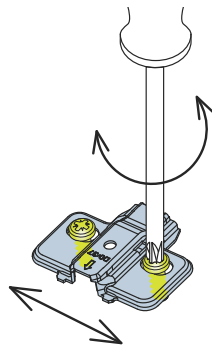

Height adjustment +2/-2mm

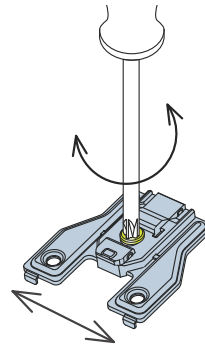

Height adjustment +2/-2mm

Mounting plate type		15		10.5	14.5			
Mounting plate thickness (D)								
Item number	Item number	Item number	Item number	Item number	Item number	Item number	Item number	
0mm	700-0NA0-054	700-0NC0-054	700-0NB0-054	700-0NF0-054	700-0NE0-054			
1mm	700-0NA1-054	700-0NC1-054	700-0NB1-054	700-0NF1-054	700-0NE1-054			
2mm	700-0NA2-054	700-0NC2-054	700-0NB2-054	700-0NF2-054	700-0NE2-054			
3mm	700-0NA3-054	700-0NC3-054	700-0NB3-054	700-0NF3-054	700-0NE3-054			
4mm	700-0NA4-054	700-0NC4-054	700-0NB4-054	700-0NF4-054	700-0NE4-054			
0mm							700-0KW0-054	
3mm							700-0KW3-054	

Legend of mounting plate type symbols

	15		10.5	15	14.5
Screw-on ready for chipboard screws ← screws	Pre-mounted 15mm euro screws	Machine insertion ready	Pre-mounted 10.5mm expanding dowels	Pre-mounted chipboard screw	Pre-mounted chipboard screw