

**NEW**

# High Performance Quickfit Dowel for Multiple Wooden Materials



## **Quickfit TL5** **‘Full Metal Jacket’**

- Effective in multiple wooden materials
- Strong and reliable joint
- High drilling tolerances
- Tool-free insertion

# Quickfit TL5 'Full Metal Jacket'

## High Performance Quickfit Dowel for Multiple Wooden Materials

**Effective performance in chipboard, solid wood and MDF**

Optimal strength and effective performance in MDF, chipboard and solid wood, without the use of wooden dowels

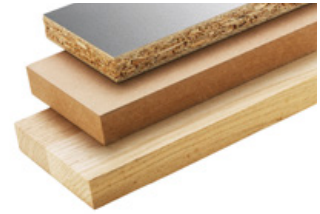

**Strong and reliable joint**

An expanding steel sleeve assures high resistance to torsion and dowel pull-out

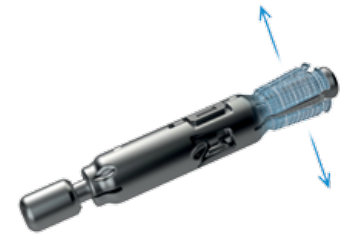

A rigid cabinet construction which doesn't loosen through time, even at repeatable assembly

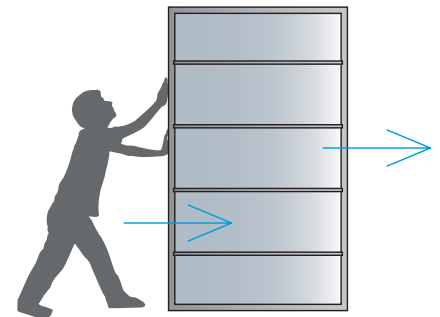

**High drilling tolerances**

An extended dowel head form works as a positive stop against cam and provides an ETHC tolerance of min. +/-1mm



ETHC=edge-to-hole centre

Fully tightened joint even at marginal inconsistencies of drilling and problems associated with the natural movement of wood panels

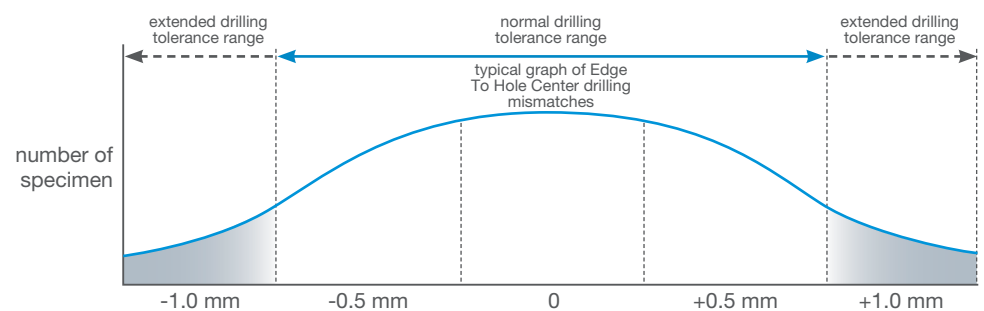

**Tool-free insertion  
for 5mm dowel holes**

Quickfit TL5 reliably engages the 5mm dowel hole

It enables the usage of tool-less Quickfit dowel insertion technology across a wide range of applications

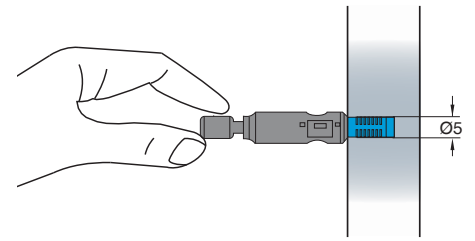

**50% less time to assemble  
the cabinet at home**

When edge inserted the dowel engages the cam and remains securely positioned until the boards are locked together

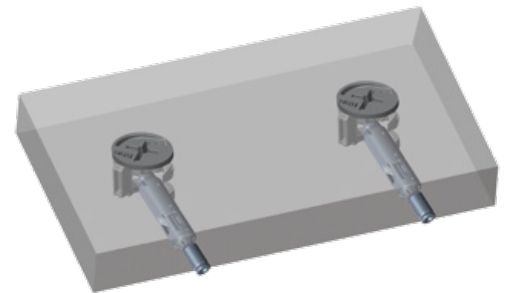

For maximum efficiency, the insertion process can be automated using Lama FastFit machine

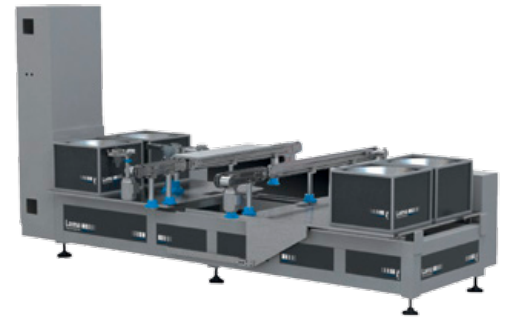

Fast and easy furniture assembly  
at home



**Technical and  
mounting details**

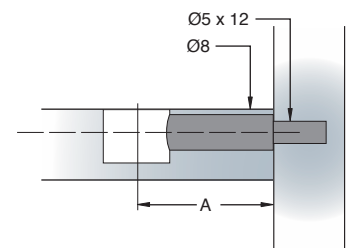

Hole diameter	5mm
Length ETHC (edge-to hole- centre) -A	24mm, 34mm
Insertion type	tool-free only
Application	manual insertion, factory insertion
Cams	works only with Cam5000
Drilling specification	Hole diameter (face board) = Ø5mm Hole depth = min. 12.5mm Hole diameter (edge board) = Ø8mm

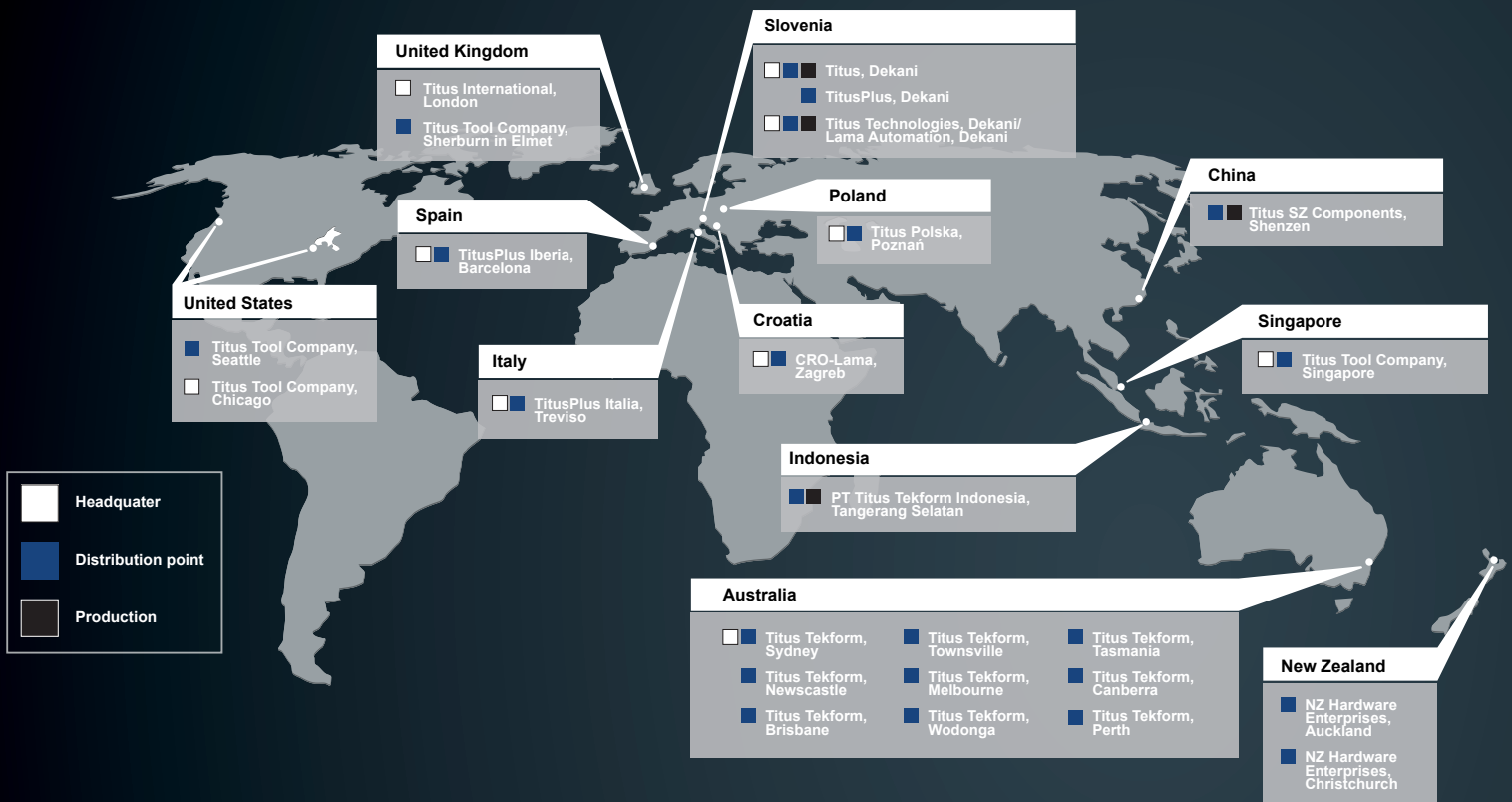

## Europe

**TitusPlus d.o.o.**  
 Dekani 5  
 SI-6271 Dekani, Slovenia  
 +386 566 90 213  
 +386 566 90 205 Fax  
 info@titusplus.com

**Titus d.o.o. Dekani**  
 Dekani 5  
 SI-6271 Dekani, Slovenia  
 +386 566 90 213  
 +386 566 90 205 Fax  
 info@titusplus.com

**Titus Technologies  
 Lama Avtomatizacija d.o.o.**  
 Dekani 5  
 SI-6271 Dekani, Slovenia  
 +386 566 90 146  
 titustechnologies@titusplus.com

**Titus Tool Company Ltd.**  
 10 Blackburn Industrial Estate  
 Enterprise Way  
 Sherburn in Elmet  
 LS256NA, United Kingdom  
 +44 1977682 582  
 +44 1977680 481 Fax  
 uk@titusplus.com

**CRO-Lama**  
 Rakitska 10a  
 Rakitje  
 HR-10437 Bestovje  
 Croatia  
 +385 1 3323 033  
 +385 1 3323 233 Fax  
 croatia@titusplus.com

**Titus Polska SP. Z O.O.**  
 ul. Stefańskiego 17 A  
 PL-62002 Suchy Las/Poznan  
 Poland  
 +4861 811 5402 Phone/Fax  
 +4861 811 5684 Phone/Fax  
 +4861 821 9362  
 poland@titusplus.com

**TitusPlus Italia Srl**  
 Via Aquileia 9  
 Frazione Olmi  
 31048 San Biagio di Callalta (TV)  
 +39 04 221 650 120  
 +39 04 221 650 136 Fax  
 italia@titusplus.com

**TitusPlus Iberia SLU**  
 C/ Luxemburg 16,  
 08520, Les Franqueses del Valles  
 +34 938 715 404  
 +34 670 349 774 Mobile  
 iberia@titusplus.com

## America

**Titus Tool Co. Inc.**  
 2800 156th Avenue SE  
 Suite 135  
 Bellevue, WA 98007, USA  
 800 762 1616 toll free  
 +1 425 746 2080  
 +1 425 746 2344 Fax  
 usa@titusplus.com

**Titus Tool Co. Inc.**  
 220 Messner Drive  
 US-60090 Wheeling, USA  
 800 762 1616 toll free  
 +1 253 872 2829  
 +1 253 872 2827 Fax  
 usa@titusplus.com

## Australia

**Titus Tekform Pty Ltd**  
 Unit 1, 41-43 Whyalla Place  
 Prestons NSW 2170  
 Australia  
 +61 2 9286 0007  
 +61 2 9826 0074 Fax  
 www.titustekform.com.au  
 info@titustekform.com.au

**NZ Hardware Enterprises Ltd**  
 34 Waipareira Avenue  
 Henderson  
 Auckland, New Zealand  
 +64 9 837 0886  
 +64 9 837 8003 Fax  
 www.titustekform.com.au  
 info@titustekform.com.au

## Asia

**Titus Tool Co. Pte. Ltd.**  
 5004 Ang Mo Kio Ave 5  
 Techplace II #04-01  
 Singapore 569872  
 +656383 3922  
 +656383 3178 Fax  
 singapore@titusplus.com

**Titus Shenzhen Components Co. Ltd**  
 1st Floor. Building No2.  
 Heng Changrong High-tech Industrial Park  
 ShangNan South Road  
 Shangjin Street  
 Baoan District Shenzhen Province  
 PRC  
 +86 755 8348 0916  
 +86 8359 2676 Fax  
 china@titusplus.com

**Titus Tekform Indonesia, PT**  
 Taman Tekno Blok L2 / 7  
 BSD Sektor XI - Tangerang 15314  
 Indonesia  
 + 62 21 7587 3578  
 + 62 21 7587 3574 Fax  
 indonesia@titusplus.com

## Headquarters

**Titus International Ltd**  
 325 Euston Road  
 London  
 NW1 3AD, United Kingdom  
 info@titusplus.com

# Titus

info@titusplus.com | www.titusplus.com